

# Chain GLC SERIES

Up-down double size lighting, various lighting style;  
End cap with magnet , cover application, easy to install;  
Built-in driver, simplifying the installation process;  
Matching corner connection, more humanization;

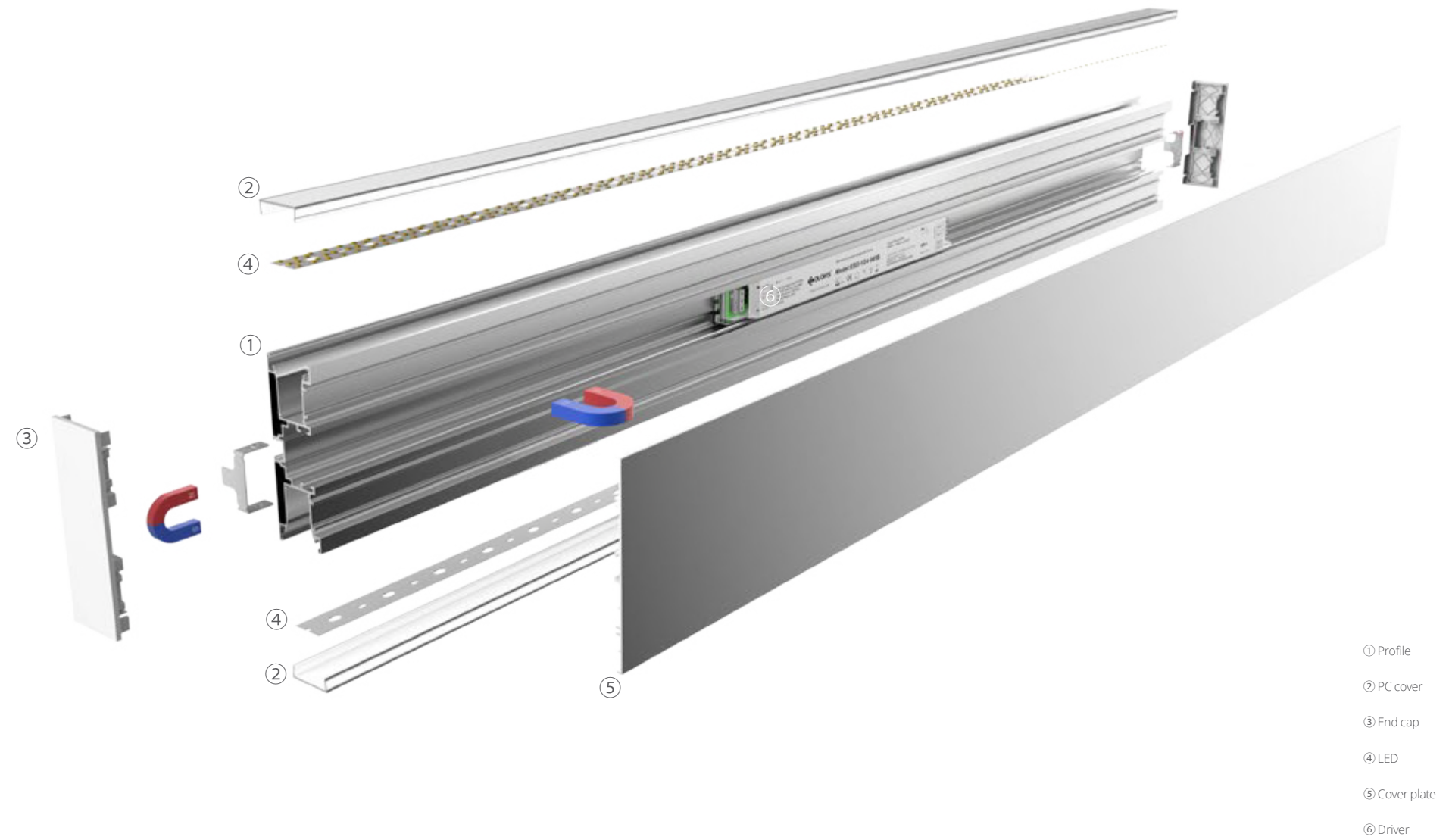

GLC 12843



**greenlux**  
cost reduction LED lighting

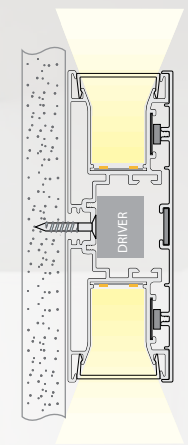
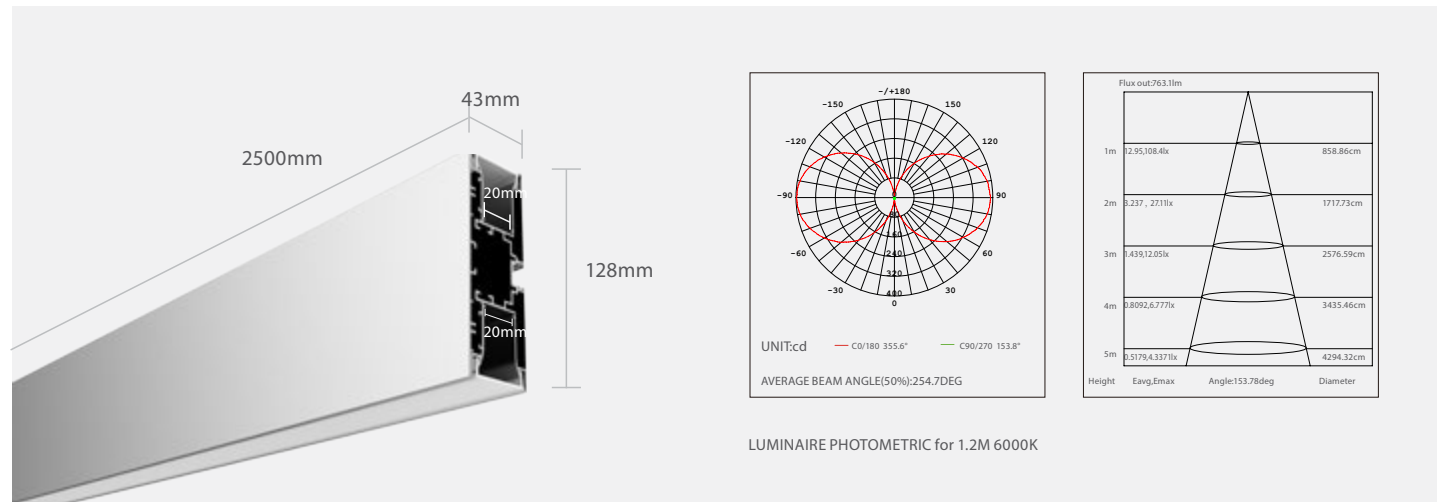

Wall Mounted

Standard



GLC12843-PRx1



GLC12843-ECx2



GLC12843-CVx2



GLC12843-CL



GLC12843-SRx1

Optional



GD8280-20



GDY8280-23



GESD-V24-0655



GLC12843-180



GLC12843-L90W



GLC12843-L90N



# Chain GLC Series Installation

Surface Mounted / Wall Mounted Diagram



- Step1: Main body installation: Profile + driver + LED + cover
- Step2: Magnet wire hanging installation kit+pedant wire
- Step3: Fixed profile body
- Step4: Install the cover

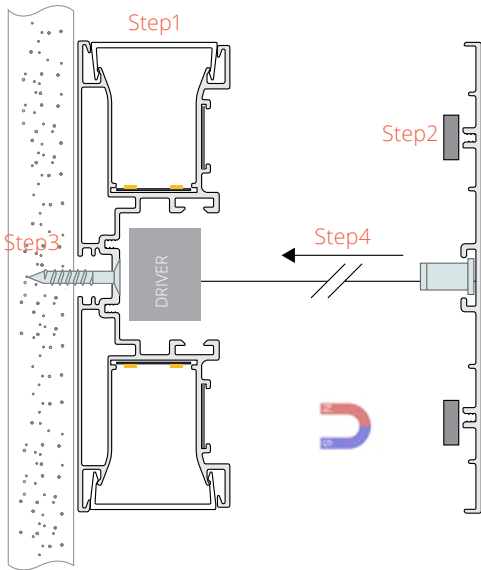
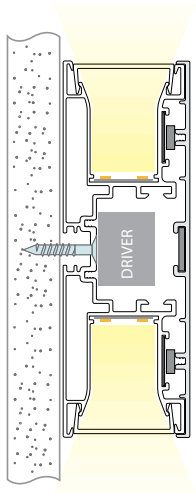

Step2

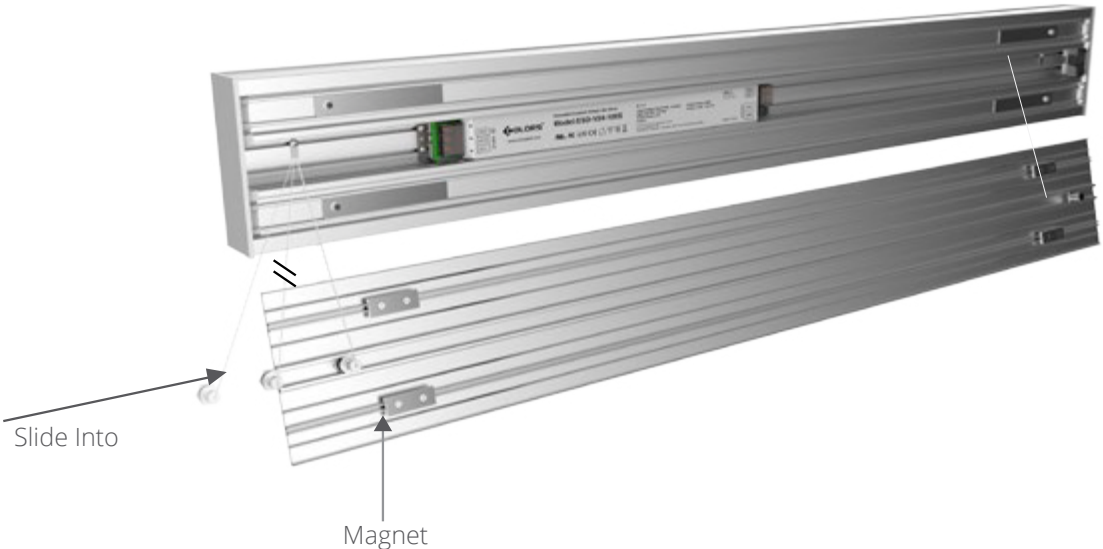
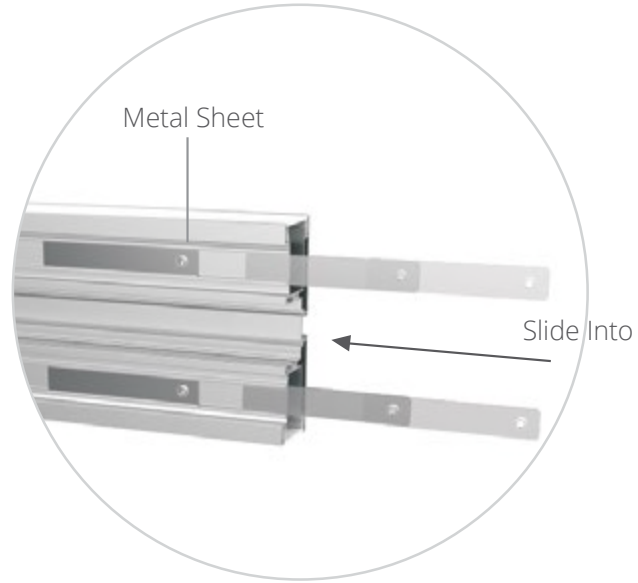

# Chain Series LED Linear Light



Home Lighting

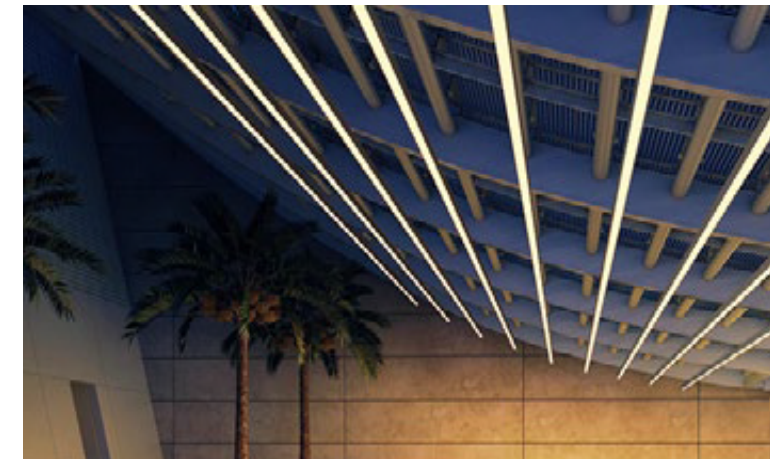

Commercial Lighting



Office Lighting



Industrial Lighting

