

Bravo 02 Series LED Wall Pack Light



Better solutions for a Led Wall Pack Light

-  **IP65 water-proof**
-  **AC100-277V 50/60Hz**
-  **Easy Installation**
-  **125Lm/w**



Options

Power MEAN WELL DRIVER Standard Dimmable 1-10V Dimmable DALI	Color 3000K 4000K 5700K
---	---

Application

LED Wall Pack Light series can be widely used as Exterior or interior LED lighting for Hotels, Garages, Commercial Buildings, Public areas, Schools and Hospitals, etc.

Specifications

Item	Power	Lumen	Leds	CRI	Weight	Beam Angle
GBBRA-30W-02	30W	3300Lm	LUMILEDS 3030	>80	1.45KG	120°
GBBRA-50W-02	50W	5500Lm	LUMILEDS 3030	>80	1.58KG	120°
GBBRA-70W-02	70W	8750Lm	LUMILEDS 3030	>80	3.60KG	120°
GBBRA-80W-02	80W	10000Lm	LUMILEDS 3030	>80	3.67KG	120°
GBBRA-100W-02	100W	12500Lm	LUMILEDS 3030	>80	3.70KG	120°

Dimensions(mm)

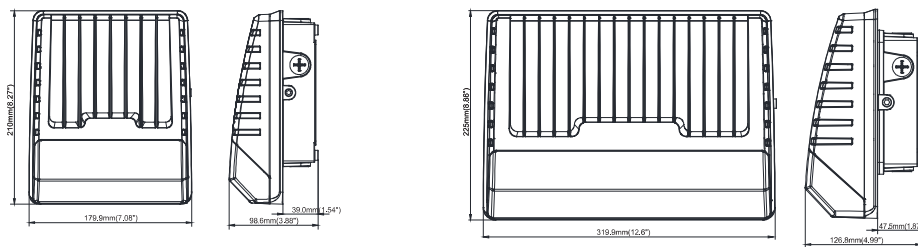

30W/50W

70W/80W/100W



Bravo 02 Series LED Wall Pack Light



Installation

P1-Mounting with J-box

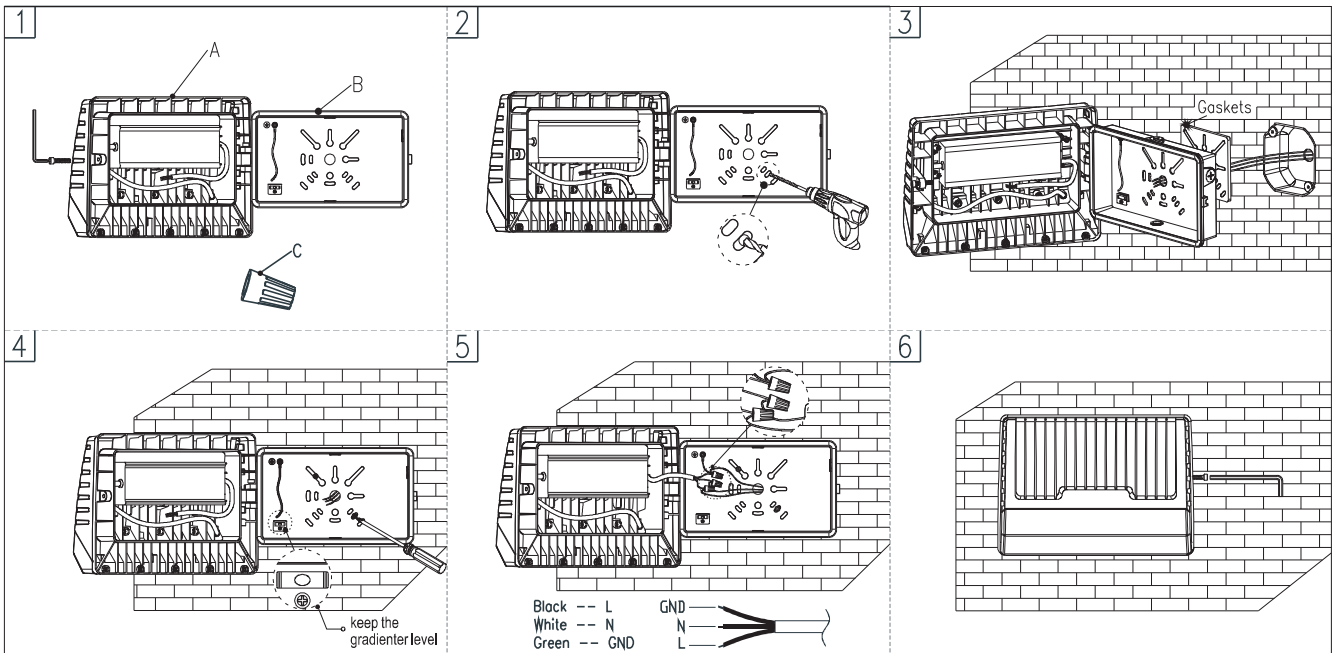

P2-Mounting with a 1/2" conduit at the bottom

