

# Eclipse Series 02 LED Wall Pack Light



## Better solutions for a Led Wall Pack Light

-  **IP65 water-proof**
-  **AC100-277V 50/60Hz**
-  **Easy Installation**
-  **135Lm/w**

**Operating Temp.:** -20°C ~+50°C      **Storage Temp.:** -40°C~+80°C

## Options

- |                                      |   |
|--------------------------------------|---|
| <b>Power</b><br>UL/TUV/CE/SAA Driver | <b>Color</b><br>3000K<br>4000K<br>5700K |
|--------------------------------------|---|



## Application

LED Wall Pack Light series can be widely used as Exterior or interior LED lighting for Hotels, Garages, Commercial Buildings, Public areas, Schools and Hospitals, etc.

## Specifications

Item	Power	Lumen	Leds	CRI	Weight	Beam Angle
GBECL-30W-WP02	30W	140lm/W	SMD 3030	>80	1.85kg	140 x 50°
GBECL-50W-WP02	50W	140lm/W	SMD 3030	>80	1.85kg	140 x 50°
GBECL-70W-WP02	70W	140lm/W	SMD 3030	>80	4.50kg	140 x 50°
GBECL-80W-WP02	80W	140lm/W	SMD 3030	>80	4.50kg	140 x 50°
GBECL-100W-WP02	100W	140lm/W	SMD 3030	>80	4.50kg	140 x 50°

## Dimensions(mm)

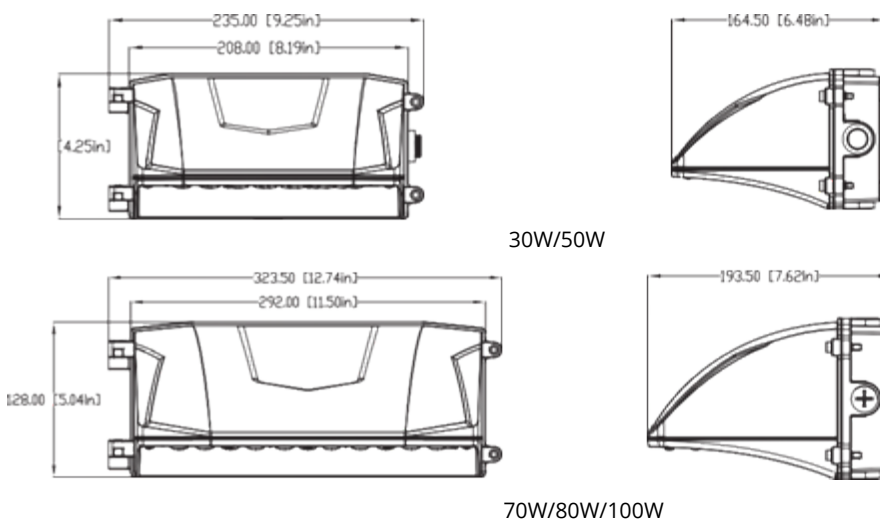

## Photometry

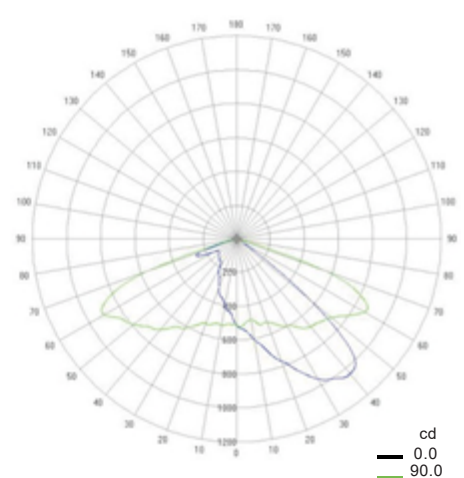

# Eclipse Series 02 LED Wall Pack Light

## Sensor Optional

Thermal Type Photocontrol  
(Button type Wire-in)



Thermal Type Photocontrol  
(Swivel & Wire-in)

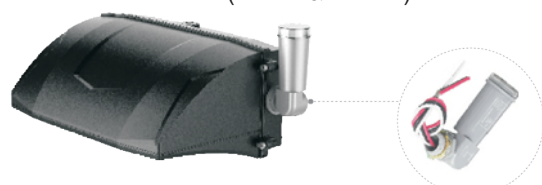

## Installation

### P1-Mounting with J-box

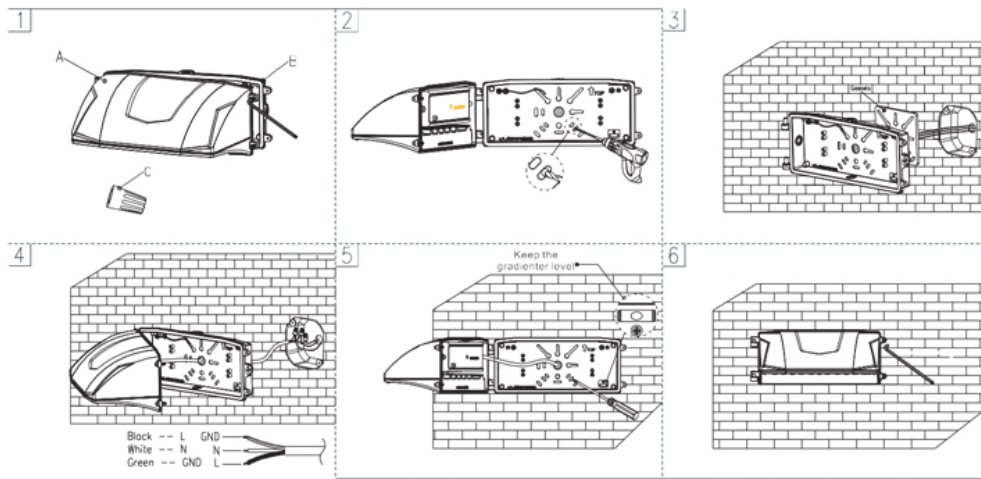

### P2-Mounting with a 1/2" conduit at the bottom

