



TL68 Series

LED Track Spotlight

Introduction



TL68 is a new design track light, adopt Citizen chip which can create a diversified and dramatic atmosphere. Elegant and concise design with internal driver, adjustable lighting orientation with 350° in horizontal direction and 90° in vertical direction, which bring a flexible exposure. Integrated die-cast aluminum and thermal convection design provide excellent heat dissipation, ensure a long lifespan.

Features

1. High quality LED source, CRI80/90/97 optional.
2. Supreme Aluminum heat sink with great heat dissipation.
3. Secondary optics with lens and reflector make more uniform light.
4. Beam angle: 15°/24°/36° for option.
5. Adjustable lighting orientation with 350° in horizontal direction and 90° in vertical direction.
6. 1-circuit and 3-circuit are all available.

Application Areas

It is suitable for supermarket, specialty store, show window, exhibition hall; focus lighting, decorative and background lighting, where attention is focused on subjects to emphasise special visual points.



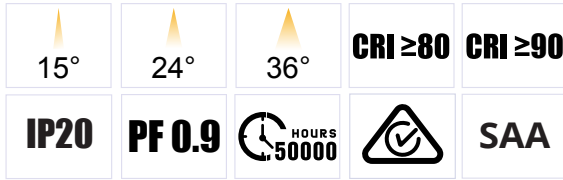

Measurement

Model	Dimension(mm)				Size(mm)	Product Weight (Kg)	
	A	B	C	D		N.W/PC	G.W/PC
GUTL68-10W-D	223	127	65	84.5	Ø65*223	0.51	0.62
GUTL68-15W	223	127	65	84.5	Ø65*223	0.51	0.62
GUTL68-25W-D	254	157	80	84.5	Ø80*254	0.805	0.935
GUTL68-25W	254	157	80	84.5	Ø80*254	0.805	0.935
GUTL68-35W-D	259	167	100	84.5	Ø100*259	1.03	1.18
GUTL68-35W	259	167	100	84.5	Ø100*259	1.03	1.18

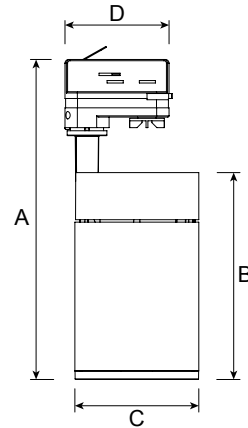

Technical Data Sheet

Model No.	GUTL68-10W-D	GUTL68-25W-D	GUTL68-35W-D	GUTL68-15W	GUTL68-25W	GUTL68-35W		
Dimension(mm)	Ø65*223	Ø80*254	Ø100*259	Ø65*223	Ø80*254	Ø100*259		
Cutout (mm)	-							
Watt(W)	10W	25W	35W	15W	25W	35W		
Rated Input Voltage(V)	AC230V							
Input Voltage(V)	AC220-240V							
LED Module Input	-							
Light Source	COB							
SDCM	-							
CCT(K)	1-CCT: 2700K/3000K/4000K/5000K							
CCT Selection DIP Switch	No							
Luminous Flux (lm) ±5%	Non-DIM	1-CCT	-			1500-1750	2500-2850	3500-4000
	DIM		950-1050	2200-2500	3000-3450	-		
	Non-DIM	3-CCT	-					
	DIM		-					
CRI	Ra>80 (Ra>90 optional)							
Beam Angle (°)	15°/24°x36							
UGR	-							
LED Driver	Built-in							
Dimming Option	Triac							
Sensor	-							
Emergency Kits	-							
Electrical Class	Class I							
Ingress Protection (IP Rating)	IP20							
Impact Resistance (IK Rating)	-							
Product Finishing(Base)	White RAL 9016 / Black RAL9005							
Materials of Optics	PC							
Materials of Housing	Aluminum							
Lifetime (hr)	50,000h							
Glow wire test (°C)	850°C							
Operating Temp. (°C)	-20°C ~45°C							
Storage Temp. (°C)	-20°C ~65°C							
Installation	Track							

Driver Datasheet (Non-Dimmable)

Total load wattage		15W±1W	25W±5%	35W±5%
Output	Output Voltage range	DC30-40V		
	Rated output current	350mA	600mA	860mA
	Line Regulation	±5%		
	Setup, Rise Time	<0.5S		
	Flickering Index	-		
Input	Input Voltage	AC 200-240V		
	Rated Input Voltage(V)	AC 230V		
	Frequency	50/60Hz		
	Input Current	-		
	Rated Input Current	0.09A	0.15A	0.2A
	Power Factor	0.9		
	THD	≤20%(230V)		
	Efficiency	84%	86%	
	No load wattage	-		
Protection	Short circuit protection	Pass		
	Over voltage protection	Pass		
	Over temperature protection	Pass		
Safety &EMC	Withstand voltage	AC1500V		
	Isolation Resistance	I/P-O/P: 500VDC, ≥100M Ω		
	Surge	L-N 500V,L,N-PG 1KV	L-N 1KV,L,N-PG 2KV	
	EMC Emission	EN55015, EN61000-3-2		
	EMC Immunity	EN61000-4-2,3,4,5,6,8,11; EN61547		

Driver Datasheet (Triac Dimmable)

Total load wattage		10W	25W	35W
Output	Output Voltage range	DC30-40V		
	Rated output current	220mA	580mA	800mA
	Line Regulation	±5%		
	Setup, Rise Time	<1S		
	Flickering Index	<10%		
Input	Input Voltage	AC 200-240V		
	Rated Input Voltage(V)	AC 230V		
	Frequency	50Hz		
	Input Current	0.06A	0.14A	0.2A
	Rated Input Current	0.05A	0.13A	0.17A
	Power Factor	0.9		
	THD	-	<20%	
	Efficiency	78%	84%	85%
	No load wattage	<1W		
Protection	Short circuit protection	Pass		
	Over voltage protection	Pass		
	Over temperature protection	Pass		
Safety &EMC	Withstand voltage	I/P-O/P:3.75kVac, <5mA 60S; I/P-FG:1.6kVac, <5mA 60; O/P-FG:0.5kVac, <5mA 60S		
	Isolation Resistance	I/P-O/P: 500VDC, ≥100M Ω		
	Surge	IEC/EN61000-4-5(L-N:0.5KV, L/N-PG:1KV)	IEC/EN61000-4-5(L-N:1KV, L/N-PG:2KV)	
	EMC Emission	EN55015, EN61000-3-2		
	EMC Immunity	EN61000-4-2,3,4,5,6,8,11; EN61547		

Installation Procedure

WARNING

1. Switch off power supply before installation / maintenance.
2. Switch on after completing installation and examination of the circuit.
3. The track spotlight must be installed and maintained by professional electrician.

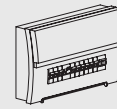

Turn off power supply before installation. Read instructions and make sure you have all the tools and accessories before installation.

Installation Guide

Step 1

Before locating Adaptor into Track Section, make sure it is set in the 'OFF' position & 'Locking Lever' is set in the position as shown below.

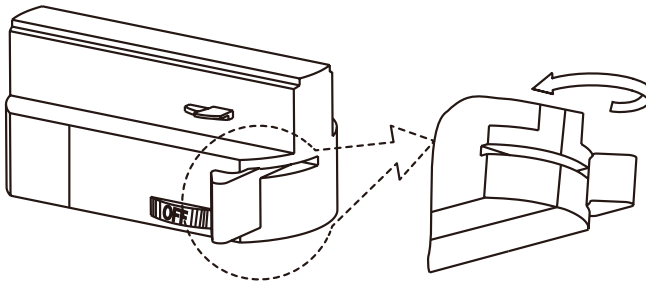

2-wires, 3-wires adaptor

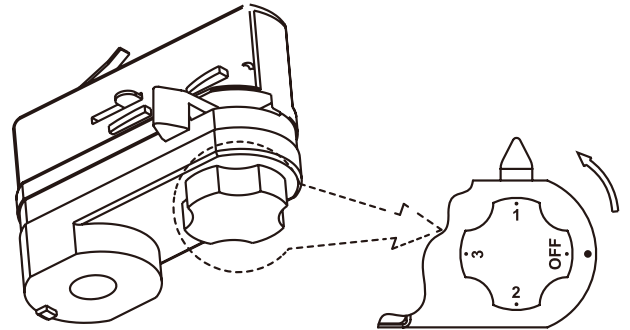

4-wires adaptor

Step 2

Locate Track Adaptor into Track Section (1) & lock into position by turning 'Locking Lever' 90°(2)

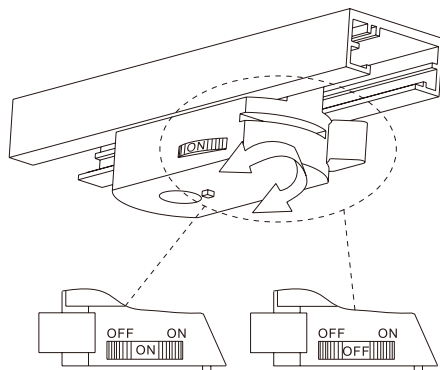

2-wires, 3-wires control luminaires in same circuit by ON/OFF switch.

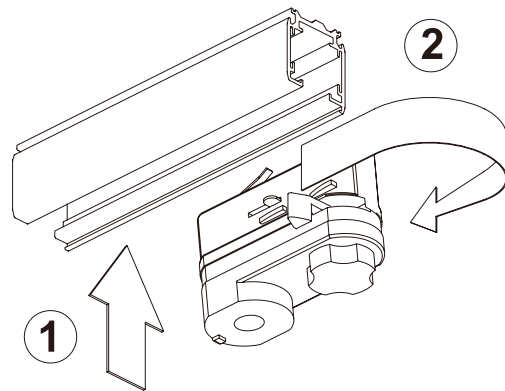

Track Section

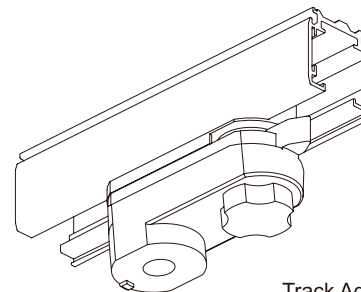

Track Adaptor shown locked into Track Section

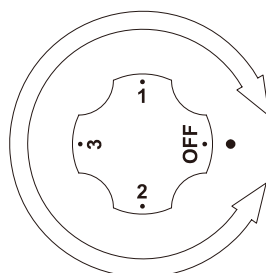

4-wires
Turn clockwise or anti-clockwise.