

## Opal BL Series

Backlit LED Panel Light 100lm/W UGR<19

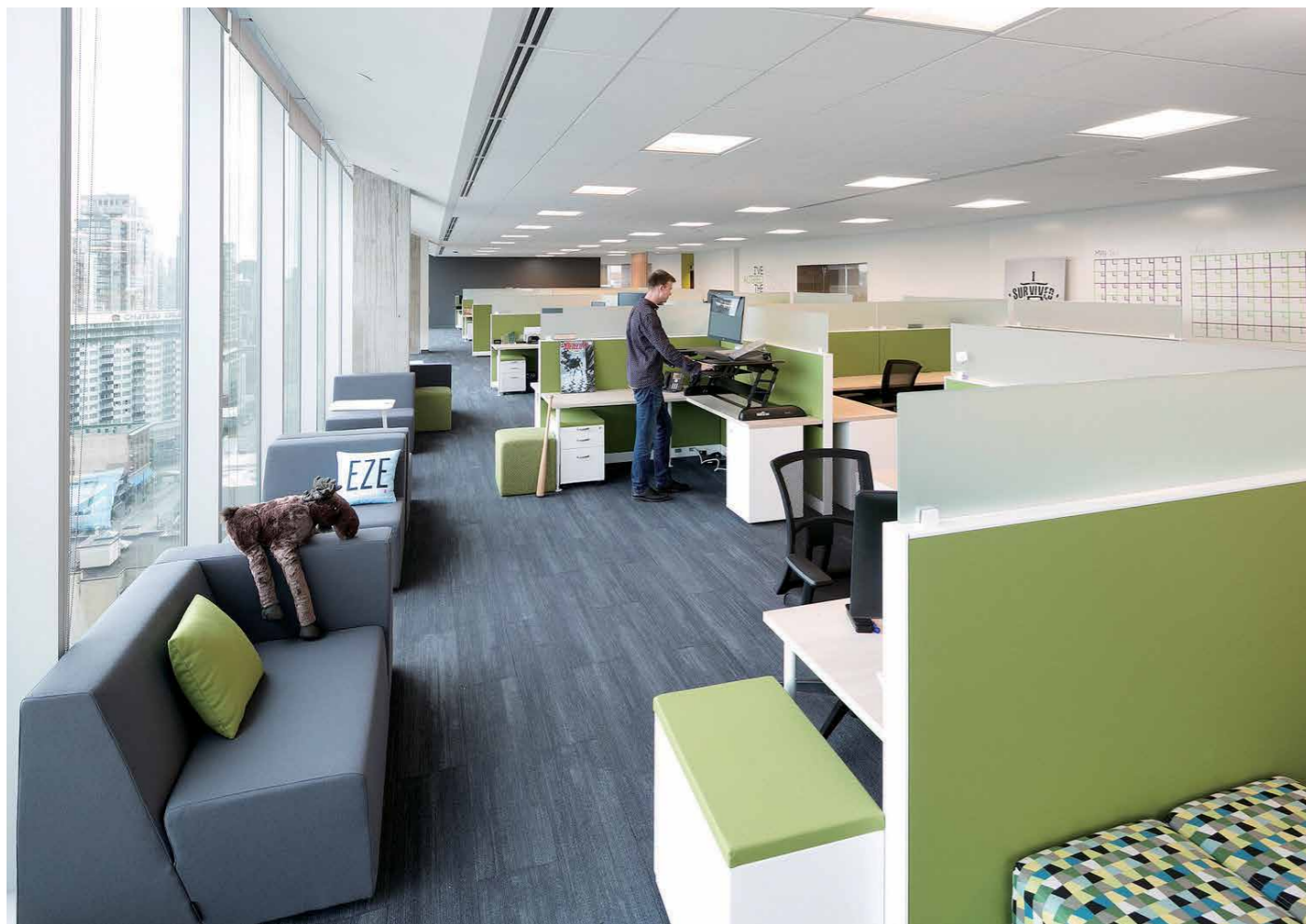



## Introduction

Backlit LED Panel Light is a direct lighting product with high lumen efficiency. It makes full use of all light and is more cost effective compared with side lighting LED panel light. Adopt optical lens to offer a uniform light effect. With integrated iron plate, it provides great thermal management.

## Features

- Uniform light effect with optic lens.
- Integrated iron plate design provides excellent thermal management.
- Concise design offers high cost performance.
- Built-out driver.
- Installation: recessed, suspended and surface mounted.

## Application Areas

Office & school lighting: office room, meeting room, class room etc. Commercial lighting: shopping mall, super market, retailer shops etc. Other situations: hospital, laboratory, dust-free workshop etc.

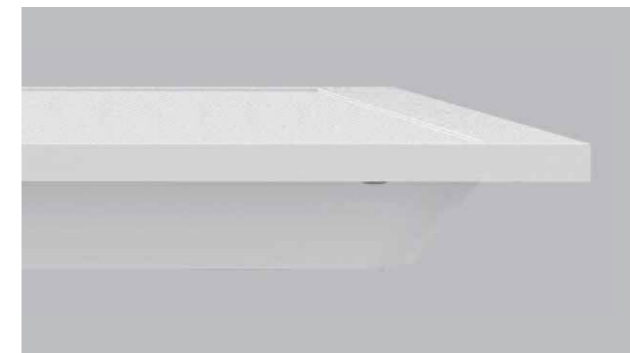
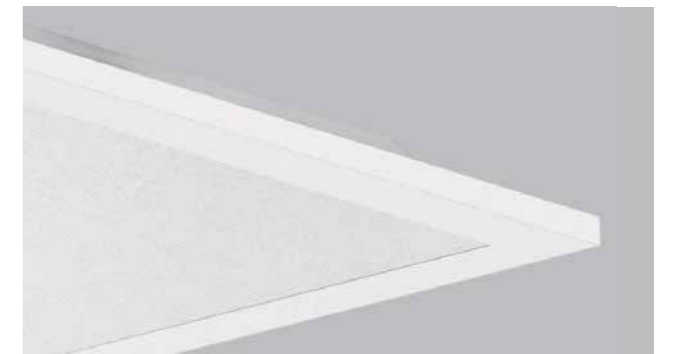
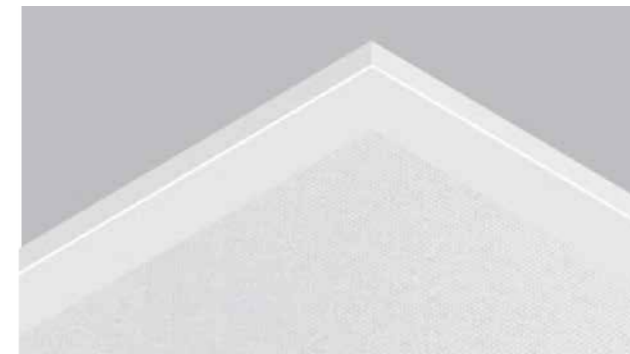
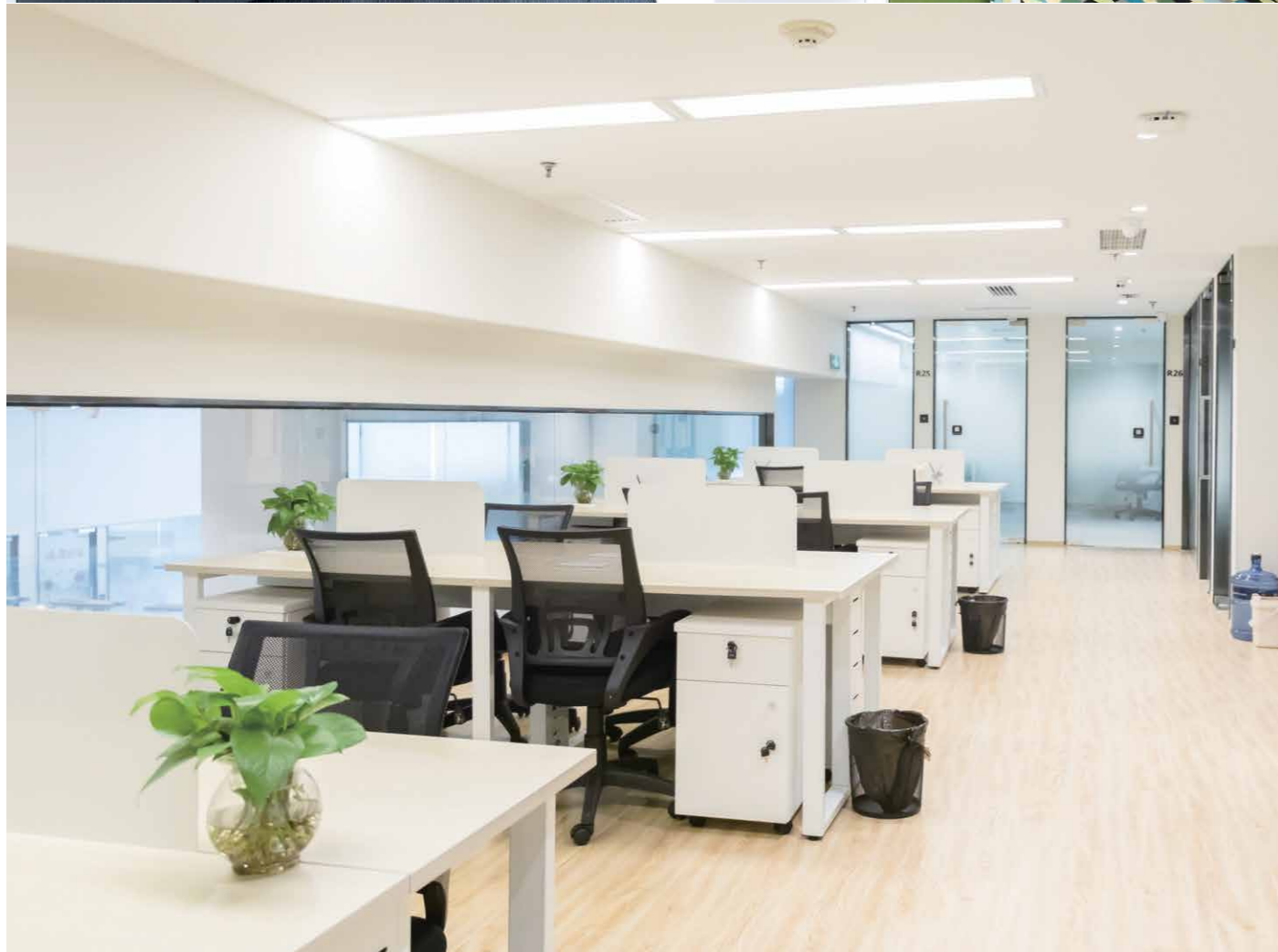



## Technical Data Sheet

Model No.	GUOPA-16W-3060-BL-100	GUOPA-36W-6060-BL-100	GUOPA-36W-6262-BL-100	GUOPA-36W-1230-BL-100	GUOPA-60W-1260-BL-100		
Dimension(mm)	295*595*32	595*595*32	620*620*32	295*1195*32	595*1195*32		
Cutout (mm)	-						
Watt(W)	16W	36W	36W	36W	60W		
Rated Input Voltage(V)	AC230						
Input Voltage(V)	AC200-240V						
LED Module Input	30-42V DC 400mA CC	30-42V DC 850mA CC	30-42V DC 850mA CC	30-42V DC 850mA CC	30-42V DC 1500mA CC		
Light Source	SMD						
SDCM	-						
CCT(K)	1-CCT: 3000K/4000K/5000K/5700K   3-CCT: 3000K+4000K+5700K						
CCT Selection DIP Switch	Yes						
Luminous Flux (lm) ±5%	Non-DIM	1-CCT	1440-1600	3240-3600	3240-3600	3240-3600	5400-6000
			DIM	1370-1520	3080-3420	3080-3420	3080-3420
	Non-DIM	3-CCT	1410-1470	3175-3300	3175-3300	3175-3300	5290-5520
			DIM	1320-1420	3010-3200	3010-3200	3010-3200
CRI	≥80 (≥90 Optional)						
Beam Angle (°)	90°						
UGR	<19						
LED Driver	Built-out						
Dimming Option	Triac / 0-10V / DALI						
Sensor	-						
Emergency Kits	-						
Electrical Class	Class II						
Ingress Protection (IP Rating)	IP40						
Impact Resistance (IK Rating)	-						
Product Finishing(Base)	White 9016						
Materials of Optics	PMMA(Lens) + PS(Diffuser)						
Materials of Housing	Aluminum(Frame)						
Lifetime (hr)	50,000h						
Glow wire test (°C)	650°C						
Operating Temp. (°C)	-20°C ~45°C						
Storage Temp. (°C)	-20°C ~65°C						
Installation	Pendant/recessed/Surface mounted.						

## Measurement

Model	Dimension(mm)				Size(mm)	Product Weight (Kg)	
	A	B	C	D		N.W/PC	G.W/PC
3060	295	595	32	9	295*595*32	1.01	1.25 2.37
6060	595	595	32	9	595*595*32	1.56	1.97 3.67
6262	620	620	32	9	620*620*32	1.98	2.44 4.55
1230	295	1195	32	9	295*1195*32	1.72	2.16 4.02
1260	595	1195	32	9	595*1195*32	3.2	3.95 7.4

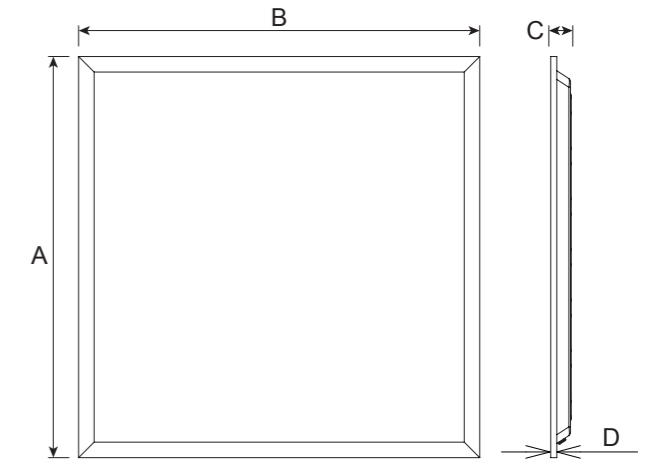

## Driver Datasheet (Non-Dimmable)

Total load wattage		16W	36W	60W
Output	Output Voltage range	DC30-42V		
	Rated output current	400mA	850mA	1500mA
	Line Regulation	±5%		
	Setup, Rise Time	≤1S		
Input	Flickering Index	-		
	Input Voltage	AC200-240V		
	Rated Input Voltage(V)	AC230V		
	Frequency	50/60Hz		
	Input Current	≤0.09A	≤0.2A	≤0.34A
	Rated Input Current	≤0.08A	≤0.18A	≤0.29A
	Power Factor	≥0.9		
	THD	<20% @230V		
	Efficiency	≥85%	≥88%	≥88%
	No load wattage	<0.5W	<0.5W	<0.5W
Protection	Short circuit protection	Pass		
	Over voltage protection	Pass		
	Over temperature protection	Pass		
Safety & EMC	Withstand voltage	AC3750V		
	Isolation Resistance	I/P-O/P: 500VDC, ≥100M Ω		
	Surge	L-N 0.5KV	L-N 1KV	L-N 1KV
	EMC Emission	EN55015, EN61000-3-2, FCC PART 15		
EMC Immunity	EN61000-4-2,3,4,5,6,8,11; EN61547, FCC PART 15			

# Installation Procedure

## WARNING ⚡

1. Switch off power supply before installation / maintenance.
2. Switch on after completing installation and examination of the circuit.
3. The panel light must be installed and maintained by professional electrician.

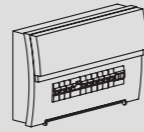

Turn off power supply before installation. Read instructions and make sure you have all the tools and accessories before installation.

## ■ Surface mounted

### Step 1

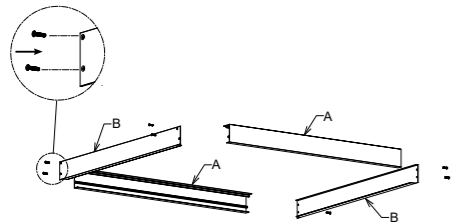

Assemble the surface mounted frame and fix by screws.

### Step 2

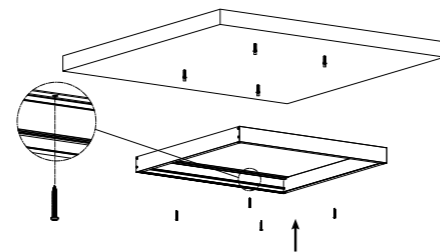

knock the plastic anchor into ceiling, fix the surface mounted frame on the ceiling by screws.

### Step 3

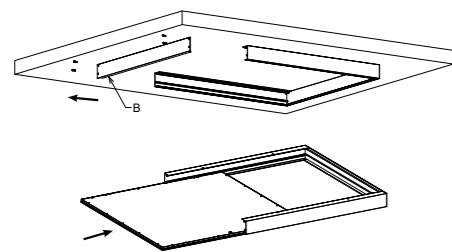

Unscrew the side frame then take out, connect the panel light to power supply, insert the panel light into the frame.

### Step 4

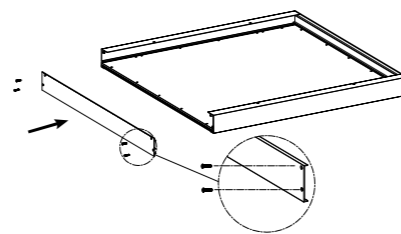

Fix the side frame back by screw.

### Step 5

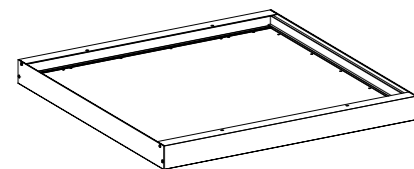

Make sure the frame and panel light are firmly fixed, turn on the power.

## ■ Recessed into ceiling

### Step 1

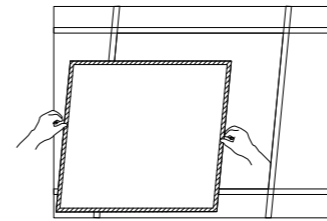

Remove the ceiling plaster slab.

### Step 2

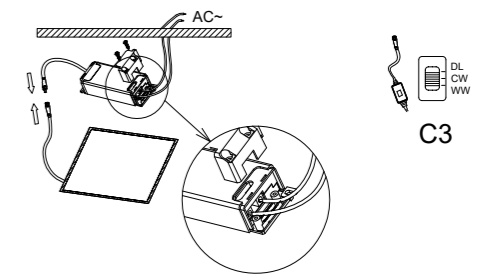

Fix 2pcs of clips to one side of frame by screw, then insert the frame into ceiling.

### Step 3

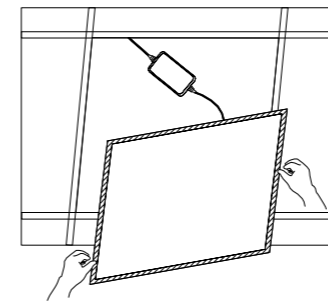

Fix the panel light into plaster ceiling.

### Step 4

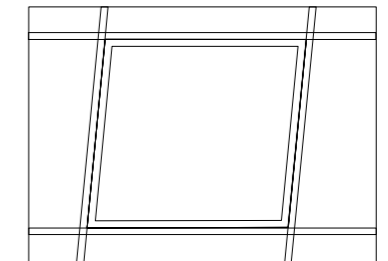

Make sure the led panel light is firmly fixed, turn on the power.

## ■ Suspending

### Step 1

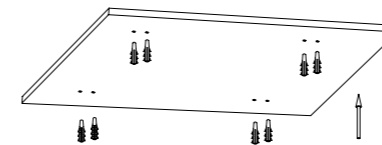

Fix the anchor into target place on the ceiling.

### Step 2

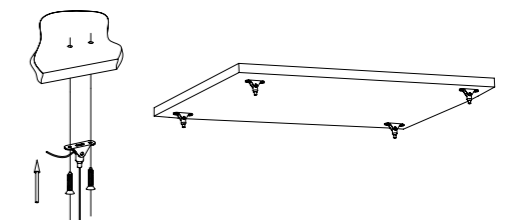

Fix the installation mount on the ceiling with plastic anchor.

### Step 3

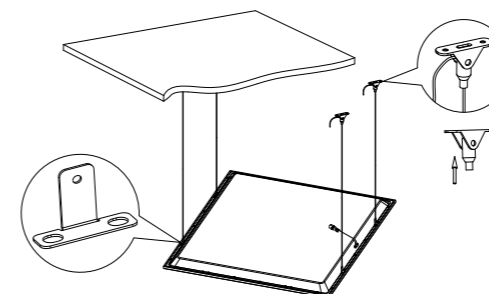

Hang the panel to ceiling with suspended installation kits, adjust the length of steeling wires.

### Step 4

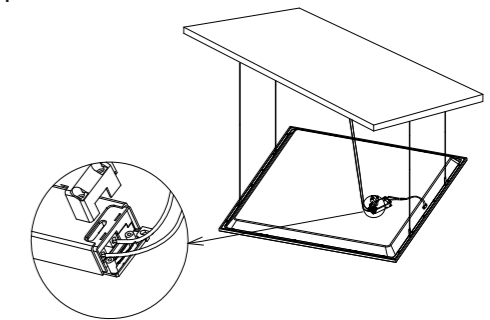

Feed the main AC wire in driver terminal block respectively, turn on the power.