

Opal GL-DH Series

LED Up/Down Hanging Panel Light



LM80

5 Yrs
Warranty



SAA

IP20

TUV

9/331 Ingles Street
Port Melbourne VIC 3207 Australia

info@greenlux.com.au
sales@greenlux.com.au

T 1300 650 625
www.greenlux.com.au



Introduction

This panel light is a novel, up & down lighting design without any screw, which makes it a special and stylish looking panel. Besides, it is an anti-glare UGR<19 design without Prism plate, this is a new tendency for high end market. Magnetic mounting box makes installation much easier.

Features

- Up & down lighting design, 3:7 light distribution.
- Anti-glare design, more uniform light output.
- Fast installation with magnetic mounting box.
- Screwless design with better look.
- Triac dim and DALI dimming options.

Application Areas

It is widely used in house lighting, office room, meeting room, restaurant etc.

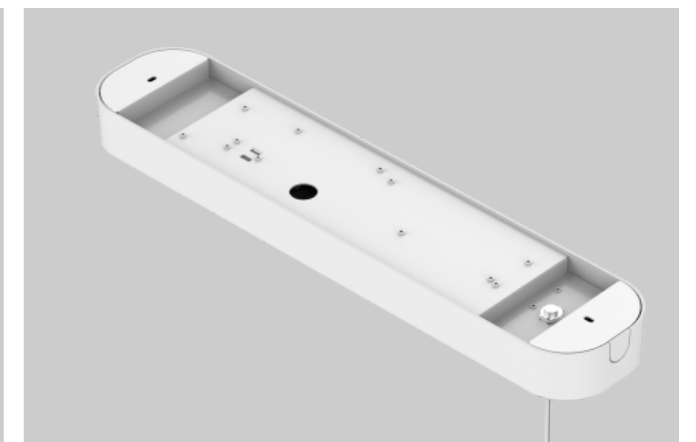
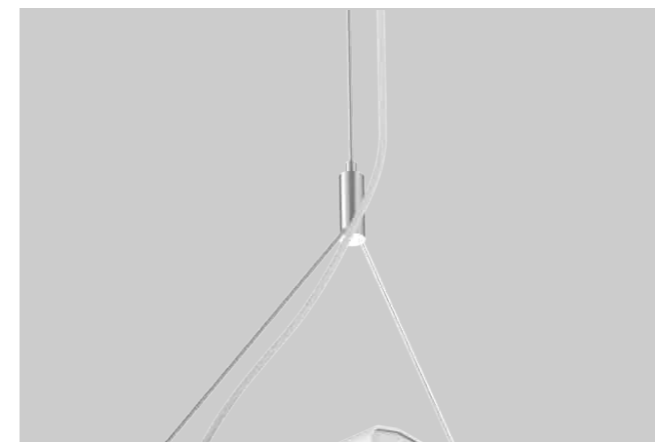

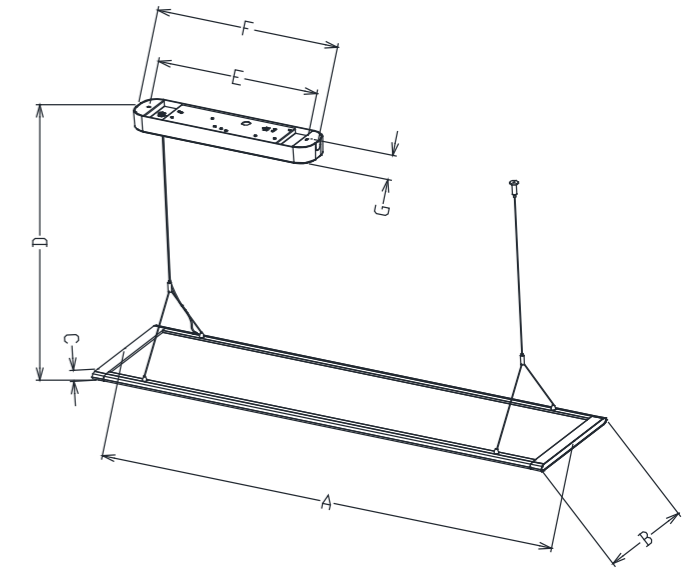
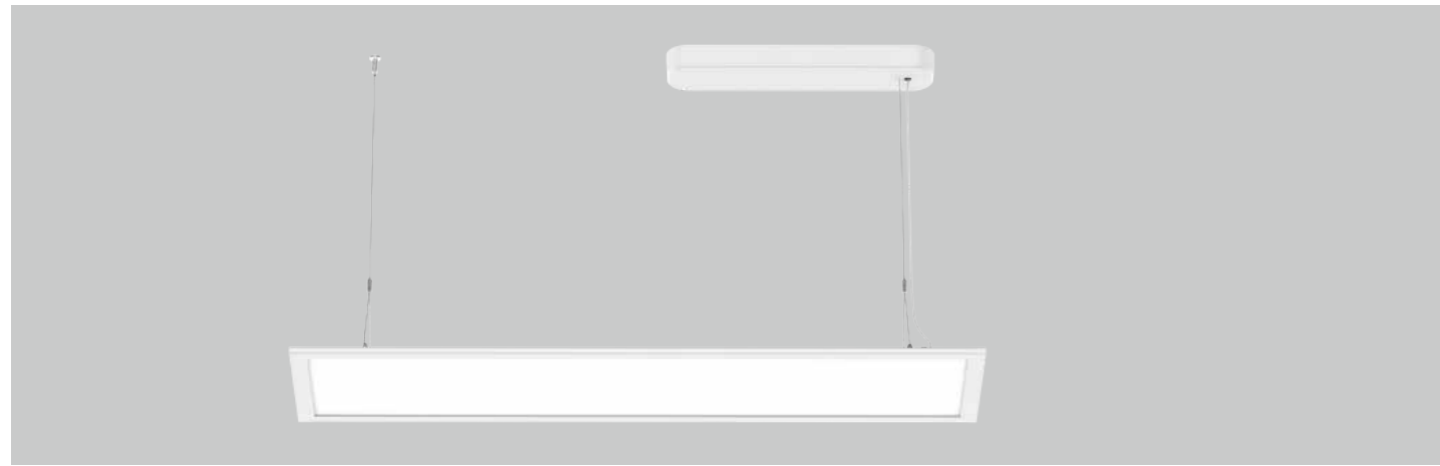

Technical Data Sheet

Model No.	GUOPA-40W-1230-DH	GUOPA-40W-1230-DH-D	GUOPA-40W-1230-DH-D-DALI		
Dimension(mm)	1200*300*16.5				
Cutout (mm)	-				
Watt(W)	40W				
Rated Input Voltage(V)	AC230V				
Input Voltage(V)	AC200-240V				
LED Module Input	-				
Light Source	SMD2835				
SDCM	<6				
CCT(K)	1-CCT: 3000K /4000K/5000K/5700K				
CCT Selection DIP Switch	NO				
Luminous Flux (lm) ±5%	Non-DIM	1-CCT	3650-4200LM	-	-
	DIM		-	3600-4100LM	3600-4100LM
	Non-DIM	3-CCT	-	-	-
	DIM		-	-	-
CRI	≥80 (≥90 Optional)				
Beam Angle (°)	110°				
UGR	<19				
LED Driver	Built-OUT				
Dimming Option	Triac/DALI				
Sensor	-				
Emergency Kits	-				
Electrical Class	Class I				
Ingress Protection (IP Rating)	IP20				
Impact Resistance (IK Rating)					
Product Finishing(Base)	White RAL 9003				
Materials of Optics	PS (Diffuser) /PMMA (LGP)				
Materials of Housing	Aluminium(frame)				
Lifetime (hr)	50,000h				
Glow wire test (°C)	650°C				
Operating Temp. (°C)	-10~40°C				
Storage Temp. (°C)	-20~50°C				
Installation	Pendant				

Measurement

Model	Dimension(mm)							Size(mm)	Product Weight (Kg)	
	A	B	C	D	E	F	G		N.W/PC	G.W/PC
GUOPA-DH	1200	300	16.5	1500	422	480	43	1200*300*16.5	3.76	5

Driver Datasheet (Non-dimmable)

Total load wattage		40W
Output	Output Voltage range	DC30-40V
	Rated output current	1000mA
	Line Regulation	±5%
	Setup, Rise Time	< 0.5S
	Flickering Index	< 7%
Input	Input Voltage	AC220-240V
	Rated Input Voltage(V)	AC230V
	Frequency	50/
	Input Current	<0.23A
	Rated Input Current	0.2A
	Power Factor	0.9
	THD	<20%
	Efficiency	> 88%
	No load wattage	< 1W
Protection	Short circuit protection	Pass
	Over voltage protection	Pass
	Over temperature protection	Pass
Safety &EMC	Withstand voltage	AC3750V 5mA/60S
	Isolation Resistance	-
	Inrush Current	IEC/EN61000-4-5(P≥25W; L-N1KV,L/N-PG:2KV)
	EMC Emission	EN55015,EN61000-3-2
EMC Immunity	EN61000-4-2,3,4,5,6,8,11; EN61547	

Driver Datasheet (Triac Dimmable)

Total load wattage		40W
Output	Output Voltage range	DC30-40V
	Rated output current	950mA
	Line Regulation	±5%
	Setup, Rise Time	<0.5S
	Flickering Index	<7%
Input	Input Voltage	AC200-240V
	Rated Input Voltage(V)	AC230V
	Frequency	50HZ
	Input Current	<0.23A
	Rated Input Current	0.2A
	Power Factor	0.9
	THD	<20%
	Efficiency	>84%
	No load wattage	<1W
Protection	Short circuit protection	Pass
	Over voltage protection	Pass
	Over temperature protection	Pass
Safety &EMC	Withstand voltage	AC3750V 5mA 60S
	Isolation Resistance	-
	Surge	IEC/EN61000-4-5(P>25W,L-N:1KV,L/N-PG:2KV)
	EMC Emission	EN55015,EN61000-3-2
	EMC Immunity	EN61000-4-2,3,4,5,6,8,11; EN61547

Driver Datasheet (Dali Dimmable)

Total load wattage		40W
Output	Output Voltage range	DC25-42V
	Rated output current	1000mA
	Line Regulation	±5%
	Setup, Rise Time	<1S
	Flickering Index	<1%
Input	Input Voltage	AC200-240V
	Rated Input Voltage(V)	AC230V
	Frequency	50/60HZ
	Input Current	<0.23A
	Rated Input Current	0.18A
	Power Factor	0.9
	THD	<20%
	Efficiency	>88%
	No load wattage	<1W

Protection	Short circuit protection	Pass
	Over voltage protection	Pass
	Over temperature protection	Pass
Safety &EMC	Withstand voltage	AC3750
	Isolation Resistance	-
	Surge	IEC/EN61000-4-5(P>25W,L-N:1KV,L/N-PG:2KV)
	EMC Emission	EN55015,EN61000-3-2
	EMC Immunity	EN61000-4-2,3,4,5,6,8,11; EN61547

Installation Procedure

WARNING ⚡

1. Switch off power supply before installation / maintenance.
2. Switch on after completing installation and examination of the circuit.
3. The panel light must be installed and maintained by professional electrician.

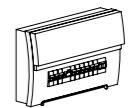

Turn off power supply before installation. Read instructions and make sure you have all the tools and accessories before installation.

How to install

Step 1

Take out panel and accessory pack from packaging.

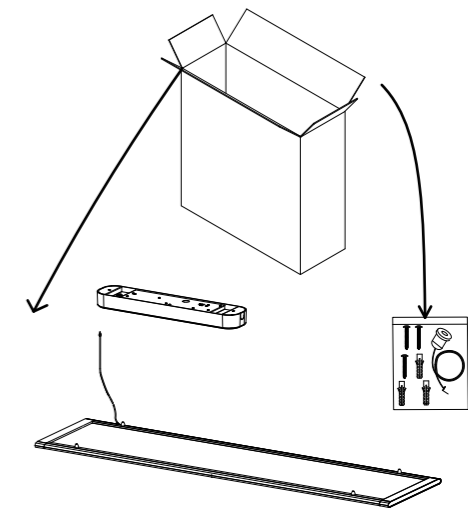

Step 2

Knock the plastic anchor into ceiling.

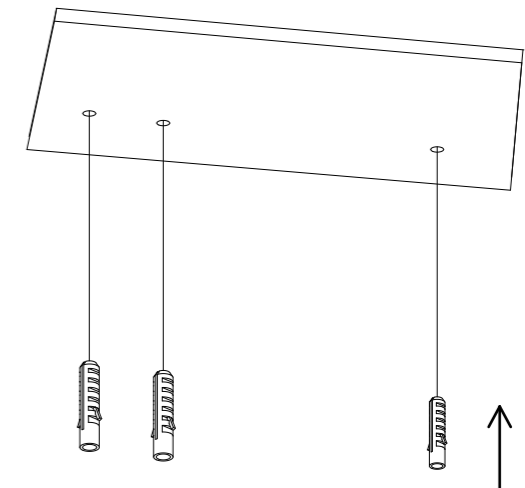

Step 3

Open the driver box, fasten the bracket and self-lock device on the ceiling.

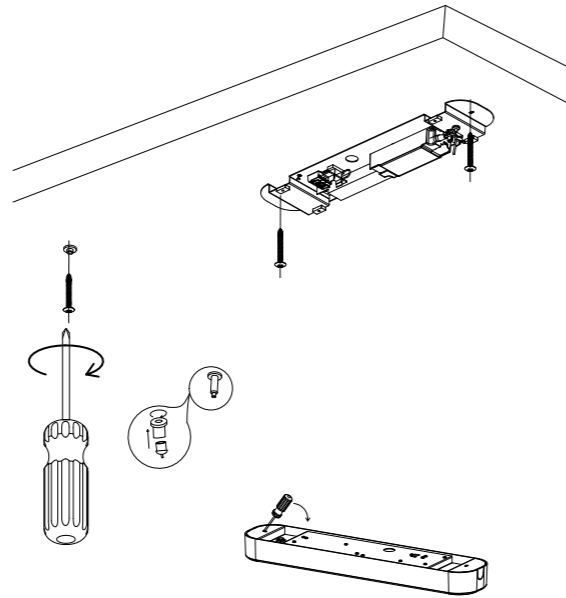

Step 6

Fix the steel wire into the end connector, connect male and female plug, then cover the mounting box.

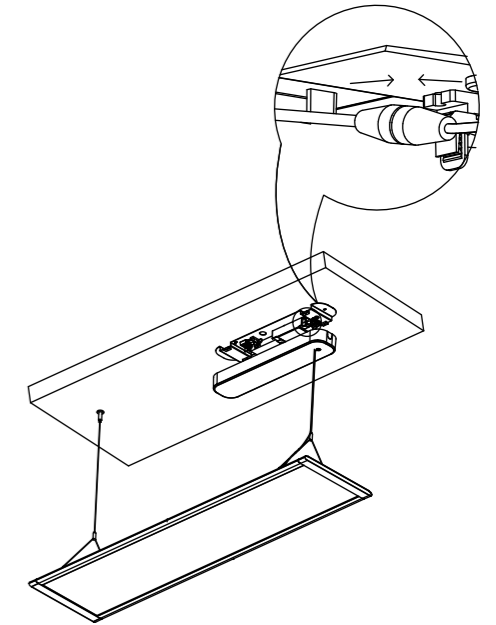

Step 4

Connect AC wire correctly, rotate the steel wire end part and fix it with the bracket.

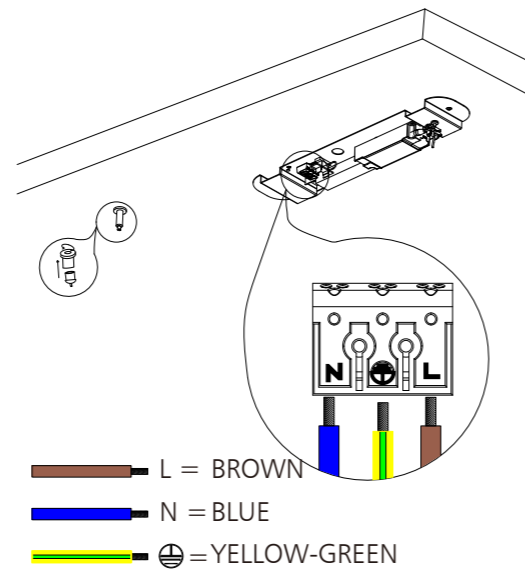

Step 7

Adjust a suitable length for steel wire, fix the wires with cable clip.

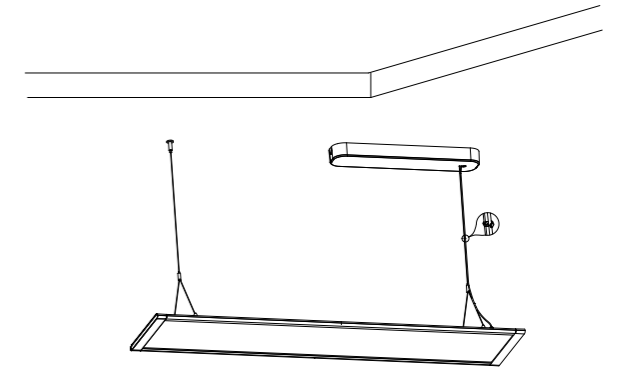

Step 5

Connect two "Y" shape steel wire with panel.

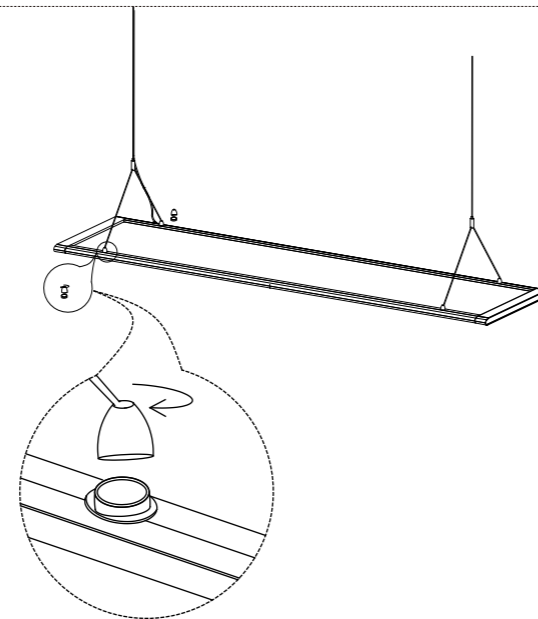

Step 8

Switch on power, installation complete.

